



H450

HISTORICAL ALUMINUM SERIES

Casement | Project-Out | Fixed



Product Material
Aluminum



Frame Depth
3 1/4"



Rating
Casement: Up to CW90
Project-Out: Up to CW90
Fixed: Up to AW100

565 Hank
Atlanta, GA
Developer: Carter Developments
Architect: Rule Joy Trammell Rubio, LLC
Contractor: New South Construction
Commercial Window Dealer: Williams Building Products



<p>Design Pressure Casement: Up to 90 Project-Out: Up to 90 Fixed: Up to 100</p>	<p>U-Value# Casement: 0.30-0.46 Project-Out: 0.30-0.46 Fixed: 0.23-0.46</p>
<p>Air Infiltration Casement: <.30 Project-Out: <.30 Fixed: <.10</p>	<p>SHGC* Casement: 0.14-0.26 Project-Out: 0.14-0.26 Fixed: 0.16-0.25</p>
<p>Water Resistance Casement: Up to 15 Project-Out: Up to 15 Fixed: Up to 15</p>	<p>CR Casement: Up to 58 Project-Out: Up to 57 Fixed: Up to 69</p>
<p>OITC Casement: Project-Out: Fixed:</p>	<p>STC Casement: Project-Out: Fixed:</p>

*-Ranges based on multiple Low-E/Argon I.G. combinations

FEATURES:

- ▶ Historically-correct bevel frame
- ▶ Casement and Project-out operating models
- ▶ Matching Fixed model
- ▶ Architectural grade aluminum frame
- ▶ Thermally-broken frame and sash with pour-and-debridge technology
- ▶ 2 5/16" narrow sitalines on operable units. 1 1/2" on fixed.
- ▶ With or without Integral Nailing Fin
- ▶ 1" insulating glass
- ▶ Exterior glazed
- ▶ Integral anchor leg
- ▶ Standard High-Performance 2604 Powder Paint Finish (an FGIA Specification). Optional upgrade to 2605 Finish (an FGIA Specification)
- ▶ 30+ "Quick-Pick" colors, with unlimited custom colors available.
- ▶ Impact rated versions (H470 Series): Project-Out model w/cam handle and Fixed model

www.QuakerCommercialWindows.com

Information listed is deemed accurate as of date shown. Quaker Windows reserves the right to change or discontinue any product, feature or option without notice.

July, 2024 V10



H450

HISTORICAL ALUMINUM SERIES

Casement Roto

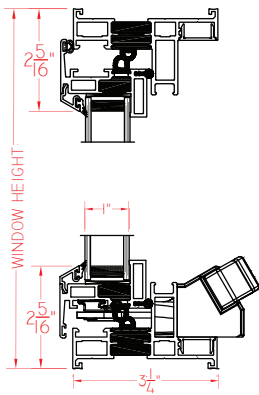

Casement Push-Out

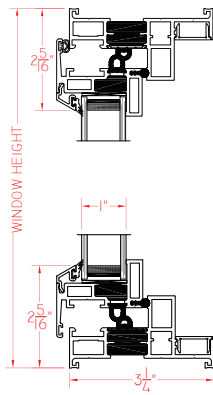

Fixed

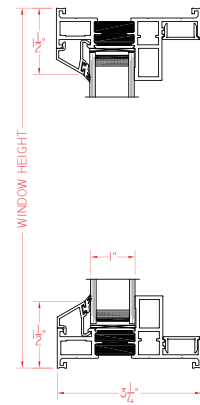

Project-Out Roto

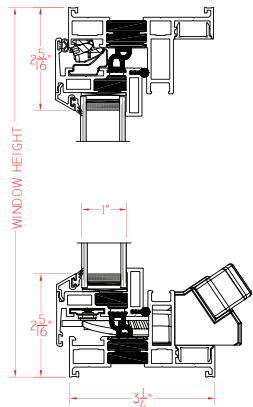

Project-Out Push-Out

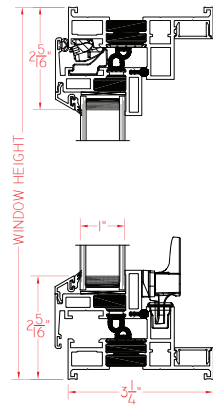

Floating Operator

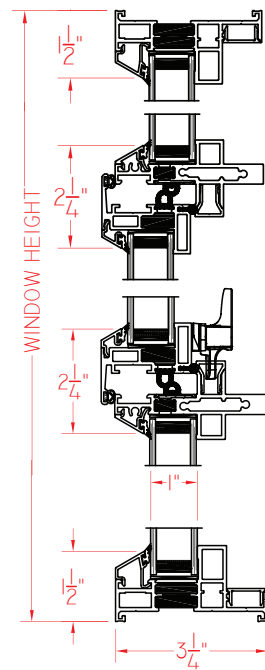

Duffey Lofts
Minneapolis, MN
Developer: Baldwin Development
Contractor: Baldwin Construction
Architect: Steven T. Christopher AIA
Glazing Contractor: S & J Glass



QuakerCommercialWindows.com
1-800-347-0438
Commercial@quakerwindows.com